

PLAN LAYOUT
SCALE: 1:1000

LEGEND - SERVICES		
PROPOSED	EXISTING	DESCRIPTION
		STORMWATER MANHOLE/PIPE
		SEWER MANHOLE/PIPE
		EFFLUENT MANHOLE/PIPE
		RAIL LINE
		COMMUNICATION MANHOLE/DUCTS
		ELECTRICAL MANHOLE/DUCTS
		WATERMAIN
		FENCE
		CATCHMENTS BOUNDARY
		EXISTING OIL LINE
		NEW STORMWATER IN ADJACENT PROJECT AREAS
		RELOCATED SERVICE
		DEMOLISH EXISTING SERVICE
		ASPHALT ROAD
		EARTH BANKS
		NEW BLOCK PAVEMENT
		PROPOSED MOUNTABLE KERB
		SETTING OUT COORDINATE: • R - RAIL EMBANKMENT • M - MULTIPURPOSE TERMINAL • S - STOCKPILE • C - CAUSEWAY • T - TRIPILER
		BENCHMARK
		NEW STILLING BASIN AND FILTER

GENERAL NOTES:

- THE CONTRACTOR WILL BE DEEMED TO HAVE INSPECTED THE SITE AND BE IN AGREEMENT WITH THE WORKS REQUIRED AS PER THE TENDER DOCUMENTS. UNLESS ALTERNATIVE PROPOSALS WITH COST IMPLICATIONS ARE RECEIVED TOGETHER WITH THE TENDER DOCUMENTS. ALTERNATIVE PROPOSALS SUBMITTED DURING CONSTRUCTION SHALL BE ON A DESIGN AND CONSTRUCT BASIS, WITH THE DESIGN AT CONTRACTOR'S EXPENSE.
- VARIATIONS DEEMED NECESSARY BY THE CONTRACTOR SHALL BE FORWARDED TO THE PROJECT MANAGER IN WRITING FOR APPROVAL BEFORE ANY CONSTRUCTION BASED ON THE VARIATION COMMENCES.
- SERVICES SHOWN ON DRAWING ARE KNOWN OR SOURCED FROM EXISTING DRAWINGS. THE CONTRACTOR MUST ENSURE THAT ALL SERVICES THAT INTERSECT OR RUN ALONGSIDE THE PROPOSED WORKS ARE LOCATED BEFORE CONSTRUCTION COMMENCES. ANY CLASHES SHALL BE REPORTED TO THE PROJECT MANAGER IN WRITING. THE CONTRACTOR SHALL BE HELD LIABLE FOR ANY DAMAGES TO EXISTING SERVICES DUE TO NEGLIGENCE.
- ALL EXISTING PIPES AND MANHOLES INCORPORATED INTO THE NEW SYSTEM SHALL HAVE DEFECTS RECTIFIED TO COMPLY TO STANDARDS FOR NEW WORKS.
- DIMENSIONS SHOWN ON DRAWINGS SHALL TAKE PREFERENCE OVER DIMENSIONS SCALED.
- ALL LEVELS AND DIMENSIONS SHALL BE CHECKED BEFORE ANY WORK COMMENCES. FAILURE TO DO SO SHALL DEEM THE CONTRACTOR LIABLE FOR ANY WORK REQUIRED TO RECTIFY ERRORS AS A RESULT OF THE FAILURE TO CHECK THE LEVELS AND DIMENSIONS.
- ALL DIMENSIONS ARE IN MILLIMETERS AND LEVELS ARE IN METERS, UNLESS OTHERWISE INDICATED.
- THE LATEST REVISION OF SANS SPECIFICATIONS SHALL APPLY. ALL WORK SHALL BE DONE IN ACCORDANCE WITH RELEVANT SANS SPECIFICATIONS, UNLESS OTHERWISE INDICATED.
- ALL LENGTHS SHOWN ARE APPROXIMATE AND SHALL BE CONFIRMED ON SITE BY CONTRACTOR.
- FOR ALL SETTING OUT COORDINATES PLEASE SEE SHEET 2.

EARTHWORKS

- ANY DISCREPANCIES IN LEVELS AND SETTING OUT DATA TO BE QUERIED WITH THE ENGINEER PRIOR TO COMMENCEMENT OF ANY WORK.
- ALL WORKMANSHIP TO BE IN ACCORDANCE WITH SANS 1200 PART D. EARTHWORKS AND THE RELEVANT PROJECT SPECIFICATIONS AS INCLUDED IN THE CONTRACT.
- BEFORE PLACING ANY FILL MATERIAL, THE EXISTING GROUND SURFACE MUST BE CLEARED AND GRUBBED OF ALL VEGETATION AND ORGANIC MATTER.
- UNLESS OTHERWISE INDICATED, ALL BANK BATTERS TO BE: 1:1.5 OUT AND 1:2 FILL.
- THE UNCOMPLICATED THICKNESS OF FILL LAYERS SHALL NOT EXCEED 300mm.
- LOCATE ALL EXISTING SERVICES IN AREA PRIOR TO ANY CONSTRUCTION TAKING PLACE.

STORMWATER NOTES

- TRENCHES FOR PIPES TO BE EXCAVATED AND BACKFILLED IN ACCORDANCE WITH THE REQUIREMENT OF SANS 1200 DB - PIPE TRENCHES.
- ALL RIGID CONCRETE PIPES SHALL HAVE CLASS B BEDDING UNLESS STATED OTHERWISE.
- FOR STORMWATER PIPES SHALL BE SPIGOT & SOCKET CLASS 1000 (SANS 677).
- ALL CONCRETE PIPE JOINTS TO BE WRAPPED WITH 12 BIDIM (NONWOVEN CONTINUOUS FILAMENT NEEDLE PUNCHED, POLYESTER/GEOTEXTILE) MIN. WIDTH TO BE 750mm FOR PIPES 3000 TO 6000.
- NO. ALL MANHOLE COVERS TO SUIT CROSSFALL OF FINISHED PAVING.
- ON COMPLETION, THE INSTALLATION SHALL BE TESTED TO THE ENGINEER'S SPECIFICATION.
- THE CONTRACTOR SHALL SUBMIT A FULL SET OF AS-BUILT DRAWINGS UPON COMPLETION OF THE INSTALLATION.
- ALL EXISTING STORMWATER PIPES, MANHOLES, CHANNELS AND ANY OTHER STORMWATER INFRASTRUCTURE TO BE CLEANED AND CLEARED OF ALL DEBRIS BEFORE ANY WORK COMMENCES. ALL DAMAGED EXISTING STORMWATER INFRASTRUCTURE SHALL BE RESTORED TO ORIGINAL CONDITION.
- ANY DISCREPANCIES IN LEVELS AND SETTING OUT DATA TO BE QUERIED WITH THE ENGINEER PRIOR TO COMMENCEMENT OF ANY WORK.
- ALL EXISTING STORMWATER PIPES ARE CONCRETE UNLESS STATED OTHERWISE.
- FOR ANY FURTHER DETAIL AND INFORMATION FOR NEW AND EXISTING STORMWATER NETWORKS, PLEASE SEE LONG SECTION DRAWINGS SHEET 1 TO 3.
- ALL EXISTING STORMWATER PIPES AND MANHOLES TO BE DEMOLISHED AND REMOVED WHERE AN UPGRADED NETWORK IS TO BE CONSTRUCTED.

BENCHMARK NAME	Y	X	Z	TYPE
PN02_SI	-93475.257	-3654091.162	5.692	Pillar Beacon
PN04_SI	-94375.598	-3652758.626	11.637	Pillar Beacon
PN05_SI	-94350.064	-3655384.385	4.526	Pillar Beacon
PN08_SI	-94121.326	-3654507.768	11.216	Pillar Beacon
CD026_SI	-97921.795	-3653141.330	5.446	Town Survey Mark
B1	-93666.668	-3653054.208	6.915	Drill Hole in Concrete
B2	-93748.380	-3653393.098	3.313	12mm Round Iron Peg
B3	-93899.392	-3653764.514	2.997	12mm Round Iron Peg
B4	-94006.972	-3654037.861	2.839	12mm Round Iron Peg
B5	-94161.158	-3654428.916	3.955	12mm Round Iron Peg
B6	-94380.974	-3654714.558	3.656	Roof Nail in Concrete
B7	-94294.497	-3655014.636	3.386	12mm Round Iron Peg
B8	-93829.849	-3654096.752	4.241	12mm Round Iron Peg
B9	-93195.652	-3653381.885	3.673	12mm Round Iron Peg
B10	-93431.837	-3653261.361	3.464	12mm Round Iron Peg

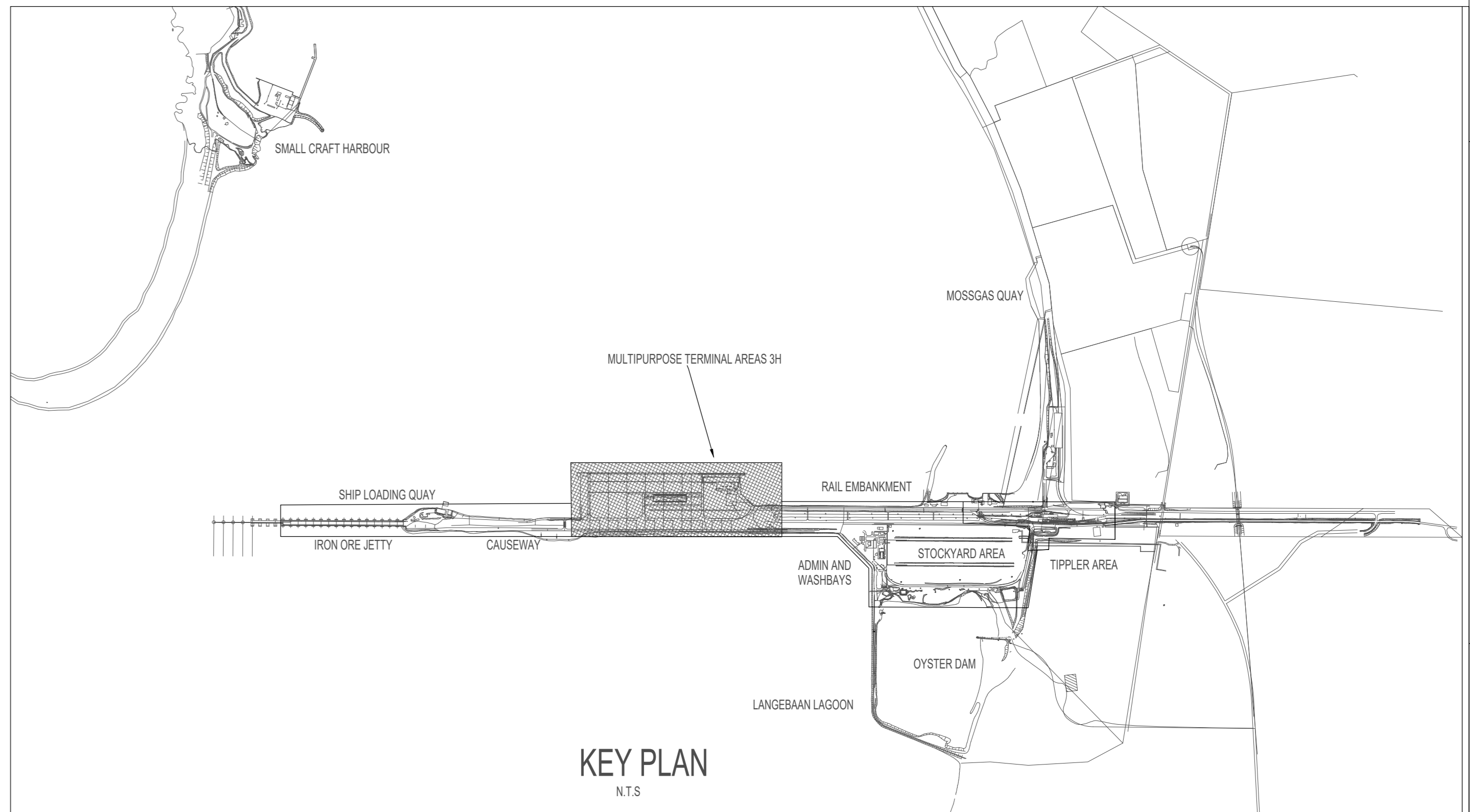

KEY PLAN
N.T.S.

DRAWING NO.	DESCRIPTION
5200157-2-001-C-LA-0004-01	MULTIPURPOSE TERMINAL STORMWATER LAYOUT & KEY PLAN
5200157-2-001-C-LA-0004-02	MULTIPURPOSE TERMINAL DETAILED LAYOUT
5200157-2-001-C-SE-0004-01	MULTIPURPOSE TERMINAL STORMWATER LONG SECTIONS SHEET 1 OF 3
5200157-2-001-C-SE-0004-02	MULTIPURPOSE TERMINAL STORMWATER LONG SECTIONS SHEET 2 OF 3
5200157-2-001-C-SE-0004-03	MULTIPURPOSE TERMINAL STORMWATER LONG SECTIONS SHEET 3 OF 3
5200157-2-001-C-LA-0004-03	MULTIPURPOSE TERMINAL DEMOLITION LAYOUT
5200157-2-001-C-DE-0004-01	MULTIPURPOSE TERMINAL STILLING BASIN DETAILS
5200157-2-001-C-DE-0001-02	TYPICAL STORMWATER MANHOLE DETAILS
5200157-2-001-C-DE-0001-03	TYPICAL STORMWATER GRID INLET & CATCHPIPS DETAILS
5200157-2-001-C-DE-0001-04	TYPICAL HEADWALL, SCOUR & CONCRETE ENCASMENT DETAILS

NOTES:

- MEASUREMENTS ARE BASED ON METRIC SYSTEM.
- ALL LEVELS ARE IN METERS TO MEAN SEA LEVELS (MSL).
- DO NOT SCALE DRAWING - ONLY DIMENSIONS SHOWN TO BE USED.
- THE CONTRACTOR SHALL VERIFY ALL SERVICES OR CONDITIONS ON THE SITE AND NOTIFY THE ENGINEERING OF ANY VARIATIONS FROM DIMENSIONS BEFORE CONSTRUCTION.

CONTRACTOR / CONSULTANT				TRANSNET PORT TERMINALS			
TITLE	NAME	SRN	DATE	TITLE	NAME	SRN	DATE
				DRAWN	HvdW		28/10/22
				CHECKED	RM		28/10/22
				DESIGNED	HvdW		28/10/22
				CHECKED	RM		28/10/22

OPERATING DIVISIONS			
TITLE	NAME	SRN	DATE

REVISIONS			
NO.	DESCRIPTION	BY	CHKD / APPD / DATE
00	ISSUED FOR CONSTRUCTION	HvdW / RM	04/08/2023
0A	ISSUED FOR CLIENT APPROVAL	HvdW / RM	28/10/2022

Transnet Port Terminals

PORT OF SALDANHA
SALDANHA STORMWATER MANAGEMENT
MULTIPURPOSE TERMINAL
STORMWATER LAYOUT

PROJECT NUMBER	0A	2	0	1	5	7	2	0	0	1	C	L	A	0	0	0	4	0	1	0	0	HD
----------------	----	---	---	---	---	---	---	---	---	---	---	---	---	---	---	---	---	---	---	---	---	----

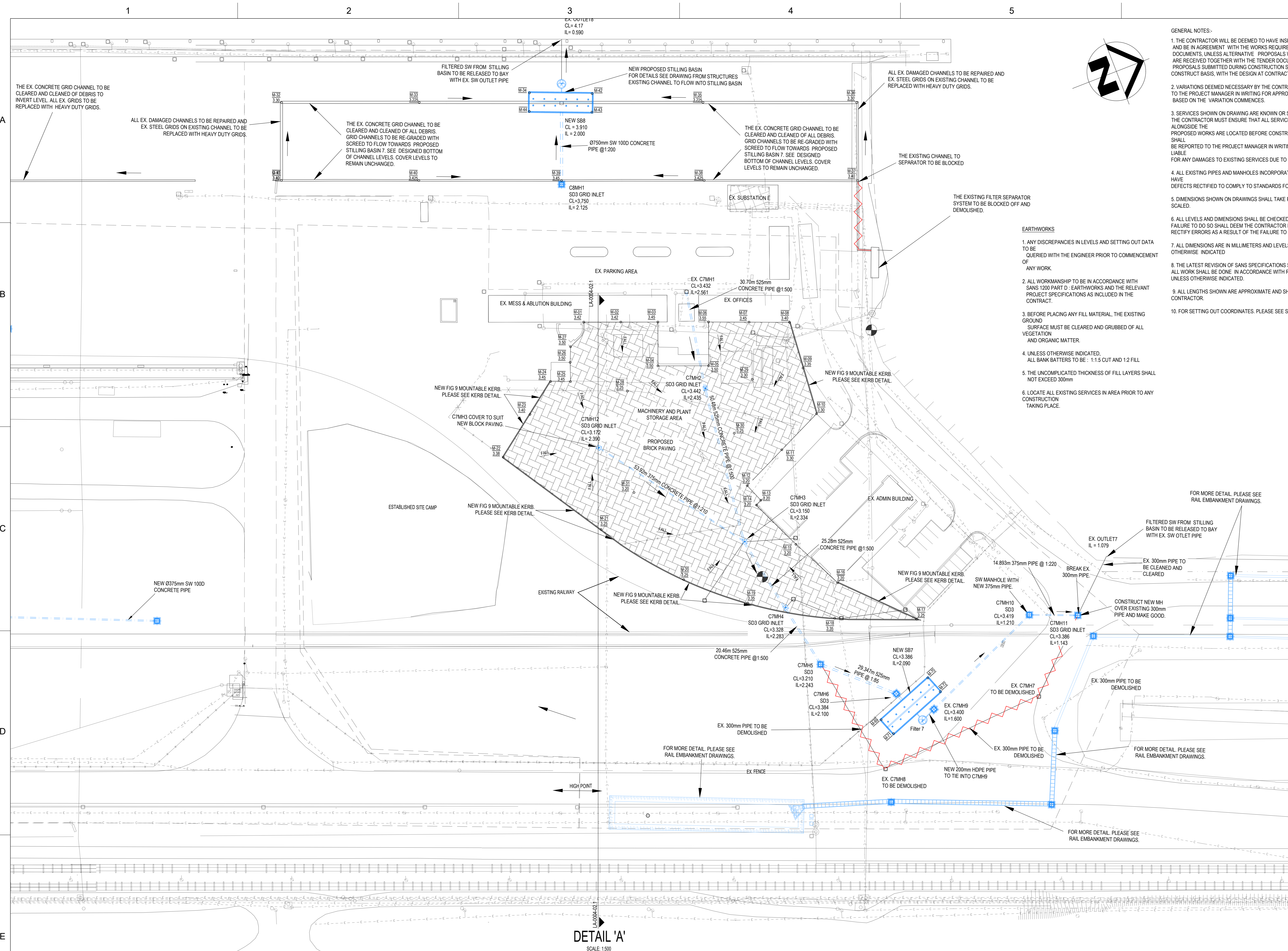

- GENERAL NOTES:-
- THE CONTRACTOR WILL BE DEEMED TO HAVE INSPECTED THE SITE AND BE IN AGREEMENT WITH THE WORKS REQUIRED AS PER THE TENDER DOCUMENTS, UNLESS ALTERNATIVE PROPOSALS WITH COST IMPLICATIONS ARE RECEIVED TOGETHER WITH THE TENDER DOCUMENTS. ALTERNATIVE PROPOSALS SUBMITTED DURING CONSTRUCTION SHALL BE ON A DESIGN AND CONSTRUCT BASIS, WITH THE DESIGN AT CONTRACTOR'S EXPENSE.
 - VARIATIONS DEEMED NECESSARY BY THE CONTRACTOR SHALL BE FORWARDED TO THE PROJECT MANAGER IN WRITING FOR APPROVAL BEFORE ANY CONSTRUCTION BASED ON THE VARIATION COMMENCES.
 - SERVICES SHOWN ON DRAWING ARE KNOWN OR SOURCED FROM EXISTING DRAWINGS. THE CONTRACTOR MUST ENSURE THAT ALL SERVICES THAT INTERSECT OR RUN ALONGSIDE THE PROPOSED WORKS ARE LOCATED BEFORE CONSTRUCTION COMMENCES. ANY CLASHES SHALL BE REPORTED TO THE PROJECT MANAGER IN WRITING. THE CONTRACTOR SHALL BE HELD LIABLE FOR ANY DAMAGES TO EXISTING SERVICES DUE TO NEGLIGENCE.
 - ALL EXISTING PIPES AND MANHOLES INCORPORATED INTO THE NEW SYSTEM SHALL HAVE DEFECTS RECTIFIED TO COMPLY TO STANDARDS FOR NEW WORKS.
 - DIMENSIONS SHOWN ON DRAWINGS SHALL TAKE PREFERENCE OVER DIMENSIONS SCALED.
 - ALL LEVELS AND DIMENSIONS SHALL BE CHECKED BEFORE ANY WORK COMMENCES. FAILURE TO DO SO SHALL BE THE CONTRACTOR'S RESPONSIBILITY FOR ANY WORK REQUIRING TO RECTIFY ERRORS AS A RESULT OF THE FAILURE TO CHECK THE LEVELS AND DIMENSIONS.
 - ALL DIMENSIONS ARE IN MILLIMETERS AND LEVELS ARE IN METERS, UNLESS OTHERWISE INDICATED.
 - THE LATEST REVISION OF SANS SPECIFICATIONS SHALL APPLY. ALL WORK SHALL BE DONE IN ACCORDANCE WITH RELEVANT SANS SPECIFICATIONS, UNLESS OTHERWISE INDICATED.
 - ALL LENGTHS SHOWN ARE APPROXIMATE AND SHALL BE CONFIRMED ON SITE BY CONTRACTOR.
 - FOR SETTING OUT COORDINATES, PLEASE SEE SHEET 2

SETTING OUT COORDINATES			SETTING OUT COORDINATES		
MH ID	X	Y	MH ID	X	Y
M57	-94487.450	3654988.763	C1MH1	-94422.732	3655504.740
M58	-94480.319	3654970.124	C1MH2	-94450.020	3655294.679
M59	-94481.849	3654980.873	C1MH3	-94472.180	3655286.557
M60	-94474.809	3654972.234	C1MH4	-94499.131	3655276.589
M61	-94454.128	3654889.529	C1MH5	-94506.444	3655266.519
M62	-94446.986	3654880.890	C1MH6	-94555.385	3655256.922
M63	-94448.616	3654901.639	C1MH8	-94568.182	3655242.152
M64	-94441.476	3654893.000	C1MH9	-94615.764	3655235.681
M65	-94427.207	3654889.948	C1MH11	-94422.201	3655231.017
M66	-94414.007	3654791.300	C1MH12	-94474.678	3655231.849
M67	-94415.697	3654812.056	C1MH13	-94465.794	3655208.175
M68	-94408.257	3654793.417	C1MH14	-94476.873	3655206.946
M69	-94140.083	3654578.984	C2MH1	-94431.705	3655209.194
M70	-94156.429	3654558.425	C2MH2	-94439.843	3655199.017
M71	-94143.507	3654574.766	C2MH3	-94466.915	3655188.925
M72	-94150.644	3654556.253	C2MH4	-94494.185	3655178.070

- STORMWATER NOTES
- TRENCHES FOR PIPES TO BE EXCAVATED AND BACKFILLED IN ACCORDANCE WITH THE REQUIREMENT OF SANS 1200 DL - PIPE TRENCHES.
 - ALL RIGID CONCRETE PIPES SHALL HAVE CLASS B BEDDING UNLESS STATED OTHERWISE.
 - FOR STORMWATER PIPES SHALL BE SPOUT & SOCKET CLASS 1000 (SANS 677).
 - ALL CONCRETE PIPE JOINTS TO BE WRAPPED WITH A BIOMIMETIC NONWOVEN CONTINUOUS FILAMENT NEEDLE PUNCHED POLYESTER GEOTEXTILE MIN. WIDTH TO BE 750mm FOR PIPES 300 TO 600.
 - NB. ALL MANHOLE COVERS TO SUIT CROSSFALL OF FINISHED PAVING.
 - ON COMPLETION, THE INSTALLATION SHALL BE TESTED TO THE ENGINEER'S SPECIFICATION OF THE INSTALLATION.
 - THE CONTRACTOR SHALL SUBMIT A FULL SET OF AS-BUILT DRAWINGS UPON COMPLETION OF THE INSTALLATION.
 - ALL EXISTING STORMWATER PIPES, MANHOLES, CHANNELS AND ANY OTHER STORMWATER INFRASTRUCTURE TO BE CLEANED AND CLEARED OF ALL DEBRIS BEFORE ANY WORK COMMENCES. ALL DAMAGED EXISTING STORMWATER INFRASTRUCTURE SHALL BE REINSTATED TO ORIGINAL CONDITION.
 - ANY DISCREPANCIES IN LEVELS AND SETTING OUT DATA TO BE QUERIED WITH THE ENGINEER PRIOR TO COMMENCEMENT OF ANY WORK.
 - ALL EXISTING STORMWATER PIPES ARE CONCRETE UNLESS STATED OTHERWISE.
 - WHERE MINIMUM COVER OF 1000mm FOR OPERATIONAL AREAS & 600mm FOR NON OPERATIONAL AREA CANNOT BE ACHIEVED CONCRETE ENCASEMENT IS REQUIRED AS PER THE DETAIL DRAWINGS.
 - FOR ANY FURTHER DETAIL AND INFORMATION FOR NEW AND EXISTING STORMWATER NETWORK, PLEASE SEE LONG SECTION DRAWINGS SHEET 1 TO 3.
 - ALL EXISTING STORMWATER PIPES AND MANHOLES TO BE DEMOLISHED AND REMOVED WHERE AN UPGRADED NETWORK IS TO BE CONSTRUCTED.

- EARTHWORKS
- ANY DISCREPANCIES IN LEVELS AND SETTING OUT DATA TO BE QUERIED WITH THE ENGINEER PRIOR TO COMMENCEMENT OF ANY WORK.
 - ALL WORKMANSHIP TO BE IN ACCORDANCE WITH SANS 1200 PART D: EARTHWORKS AND THE RELEVANT PROJECT SPECIFICATIONS AS INCLUDED IN THE CONTRACT.
 - BEFORE PLACING ANY FILL MATERIAL, THE EXISTING GROUND SURFACE MUST BE CLEARED AND GRUBBED OF ALL VEGETATION AND ORGANIC MATTER.
 - UNLESS OTHERWISE INDICATED, ALL BANK BATTERS TO BE: 1:1.5 CUT AND 1:2 FILL.
 - THE UNCOMPLICATED THICKNESS OF FILL LAYERS SHALL NOT EXCEED 300mm.
 - LOCATE ALL EXISTING SERVICES IN AREA PRIOR TO ANY CONSTRUCTION TAKING PLACE.

LEGEND - SERVICES		
PROPOSED	EXISTING	DESCRIPTION
		STORMWATER MANHOLE/PIPE
		SEWER MANHOLE/PIPE
		EFFLUENT MANHOLE/PIPE
		RAIL LINE
		COMMUNICATION MANHOLE/DUCTS
		ELECTRICAL MANHOLE/DUCTS
		WATERMAIN
		FENCE
		CATCHMENTS BOUNDARY
		EXISTING OIL LINE
		NEW STORMWATER IN ADJACENT PROJECT AREAS
		RELOCATED SERVICE
		DEMOLISH EXISTING SERVICE
		ASPHALT ROAD
		EARTH BANKS
		NEW BLOCK PAVING
		PROPOSED MOUNTABLE KERB
		SETTING OUT COORDINATE
		R - RAIL EMBANKMENT
		M - MULTI PURPOSE TERMINAL
		S - STOCKPILE
		C - CAUSEWAY
		T - TRIPPLER
		BENCHMARK
		NEW STILLING BASIN AND FILTER

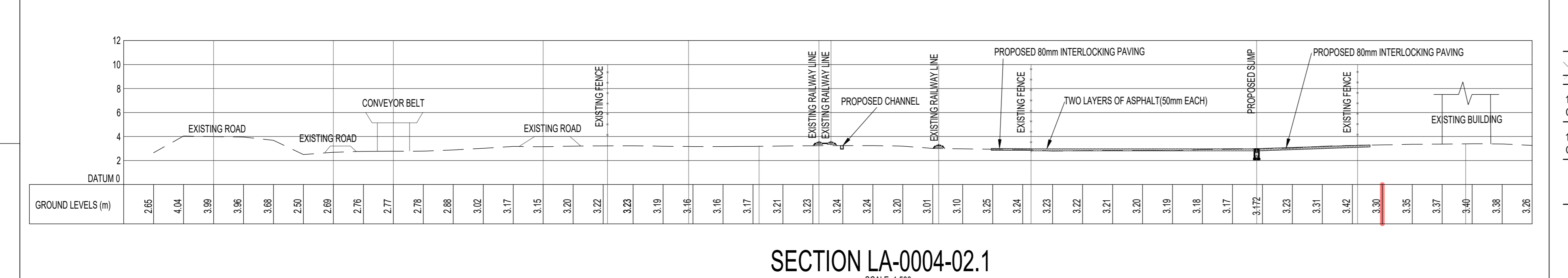

BLOCK PAVING NOTES:-

- NEW PAVING BLOCKS FFL TO SUIT AND THE INTO ALL EXISTING BUILDINGS, KERBS, PAVING SLABS, ROADS AND NEW MANHOLES.

BENCHMARK NAME	Y	X	Z	TYPE
PN02_S1	93475.257	3654911.621	5.692	Pillar Beacon
PN04_S1	94375.598	3652758.026	11.637	Pillar Beacon
PN05_S1	94350.894	3655398.365	4.526	Pillar Beacon
PN06_S1	94121.326	3654507.768	11.216	Pillar Beacon
2D025_S1	97921.795	3653141.320	5.446	Turn Survey Mark
B1	93668.668	3653054.208	6.915	Drill Hole in Concrete
B2	93748.380	3653392.098	3.313	12mm Round Iron Peg
B3	93889.392	3653704.514	2.997	12mm Round Iron Peg
B4	94008.972	3654037.881	2.839	12mm Round Iron Peg
B5	94148.158	3654428.016	3.055	12mm Round Iron Peg
B6	94380.974	3654714.558	3.666	Roof Nail in Concrete
B7	94294.457	3655201.636	3.386	12mm Round Iron Peg
B8	93829.869	3654096.752	4.241	12mm Round Iron Peg
B9	93195.652	3653381.885	3.673	12mm Round Iron Peg
B10	93431.837	3653261.361	3.484	12mm Round Iron Peg

REFERENCE DRAWINGS

DRAWING NO.	DESCRIPTION
5200157-2-001-C-LA-0004-01	MULTIPURPOSE TERMINAL STORMWATER LAYOUT & KEY PLAN
5200157-2-001-C-LA-0004-02	MULTIPURPOSE TERMINAL DETAILED LAYOUT
5200157-2-001-C-SE-0004-01	MULTIPURPOSE TERMINAL STORMWATER LONG SECTIONS SHEET 1 OF 3
5200157-2-001-C-SE-0004-02	MULTIPURPOSE TERMINAL STORMWATER LONG SECTIONS SHEET 2 OF 3
5200157-2-001-C-SE-0004-03	MULTIPURPOSE TERMINAL STORMWATER LONG SECTIONS SHEET 3 OF 3
5200157-2-001-C-LA-0004-03	MULTIPURPOSE TERMINAL DEMOLITION LAYOUT
5200157-2-001-C-DE-0004-01	MULTIPURPOSE TERMINAL STILLING BASIN DETAILS
5200157-2-001-C-DE-0001-02	TYPICAL STORMWATER MANHOLE DETAILS
5200157-2-001-C-DE-0001-03	TYPICAL STORMWATER GRID INLET & CATCHPIPS DETAILS
5200157-2-001-C-DE-0001-04	TYPICAL HEADWALL, SCOUR & CONCRETE ENCASEMENT DETAILS

- NOTES:
- MEASUREMENTS ARE BASED ON METRIC SYSTEM.
 - ALL LEVELS ARE IN METERS TO MEAN SEA LEVELS (MSL).
 - DO NOT SCALE DRAWING - ONLY DIMENSIONS SHOWN TO BE USED.
 - THE CONTRACTOR SHALL VERIFY ALL SERVICES OR CONDITIONS ON THE SITE AND NOTIFY THE ENGINEERING OF ANY VARIATIONS FROM DIMENSIONS BEFORE CONSTRUCTION.

CONTRACTOR / CONSULTANT

TITLE	NAME	SIGN	DATE	TITLE	NAME	SIGN	DATE
DESIGNED				CHECKED			
DESIGNED				CHECKED			
CHECKED				CHECKED			

OPERATING DIVISIONS

TITLE	NAME	SIGN	DATE
ISSUED FOR CONSTRUCTION	H.W.W.	R.M.	04/08/2023
ISSUED FOR CLIENT APPROVAL	H.W.W.	R.M.	28-10-2022

REVISIONS

NO.	DESCRIPTION	BY	CHKD	APPD	DATE
01	ISSUED FOR CONSTRUCTION	H.W.W.	R.M.	R.N.	04/08/2023
02	ISSUED FOR CLIENT APPROVAL	H.W.W.	R.M.	R.N.	28-10-2022

TRANSNET PORT TERMINALS

TITLE	NAME	SIGN	DATE	TITLE	NAME	SIGN	DATE
DESIGNED				CHECKED			
DESIGNED				CHECKED			
CHECKED				CHECKED			

OPERATING DIVISIONS

TITLE	NAME	SIGN	DATE
ISSUED FOR CONSTRUCTION	H.W.W.	R.M.	04/08/2023
ISSUED FOR CLIENT APPROVAL	H.W.W.	R.M.	28-10-2022

REVISIONS

NO.	DESCRIPTION	BY	CHKD	APPD	DATE
01	ISSUED FOR CONSTRUCTION	H.W.W.	R.M.	R.N.	04/08/2023
02	ISSUED FOR CLIENT APPROVAL	H.W.W.	R.M.	R.N.	28-10-2022

TRANSNET PORT TERMINALS

PORT OF SALDANHA

SALDANHA STORMWATER MANAGEMENT

MULTIPURPOSE TERMINAL

DETAILED LAYOUT

PROJECT NUMBER: 05 | 20 | 15 | 7 | 2 | 0 | 1 | 1 | C | L | A | 0 | 0 | 4 | 0 | 2 | 0 | 1 | HD

